

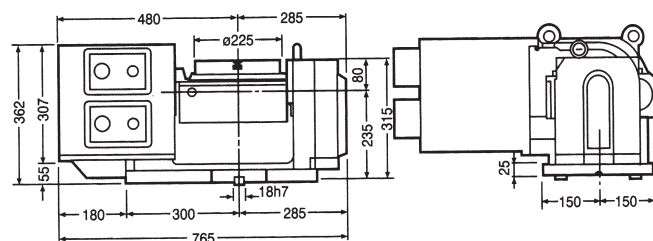

NC Tilting Rotary Table

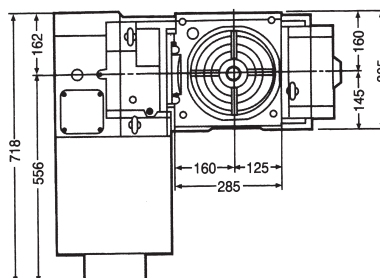
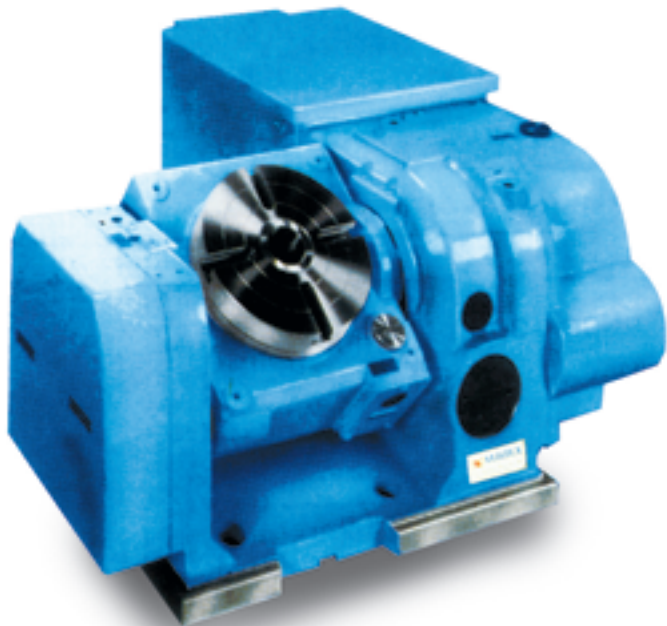

VTNC-201

- **Wide Inclination Angle $\pm 110^\circ$**
for both right and left hand sides.

● ACCURACY STANDARD

Unit:mm

NO.	Inspection Item		Tolerance
1	Table top flatness (concave)	Per overall length	0.01
2	Table top runout		0.015
3	Parallelism of table top and frame bottom	Per overall length	0.02
4	Parallelism of inclination axis center line and frame bottom	Per overall length	0.02
5	Table spindle center bore runout		0.01
6	Tilting accuracy		45" 60
7	Cumulative indexing accuracy		(20") 15"
8	Parallelism of table top and frame bottom guide block	Per overall length	0.02

□ In the case of between 180° ($-90^\circ \sim +90^\circ$)

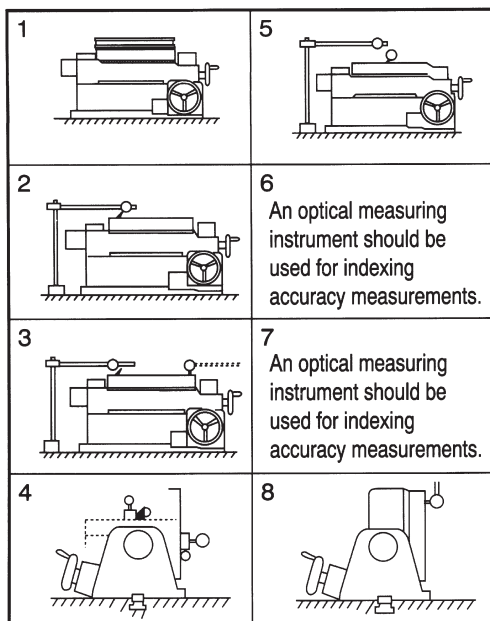

● SPECIFICATIONS

Order NO.	VTNC-201	
Turntable diameter	$\varnothing 225$	
Table height (Horizontal pos.)	315 (330)	
Overall height (Vertical pos.)	395	
Table center height (Vertical pos.)	235	
Center bore diameter	$\varnothing 40H7 \varnothing 70H7$	
Spindle hole diameter	$\varnothing 32 \varnothing 70.5$	
T-slot size	12H7	
Guide-block size	18H7	
Servo motor type	Rotation	Inclination
	FANUC $\alpha 6$	FANUC $\alpha 6$
Speed reduction ratio	1/360	1/360
Table gyration angle per 1 pulse	0.001	0.001
Table rotation speed	5.5r.p.m.	5.5r.p.m.
	/(Motor 2,000r.p.m.)	/(Motor 2,000r.p.m.)
Load capacity	0° tilt angle (kg)	100
	$0^\circ \sim 90^\circ$ tilt angle (kg)	50
	Movable load moment on the table (kg-m)	16
Inertia force (kg-cm-sec ²)	6.4	
Max. torque of worm gear (kg-m)	48	
Max. diameter of workpiece	$\varnothing 225$	
Rotation axis	Clamp torque (kg-m)	50(Hydraulic 35/cm ²)
	Cumulative accuracy (sec.)	15" (20")
	Repeatability (sec.)	4"
Inclination axis	Clamp torque (kg-m)	50(Hydraulic 35/cm ²)
	Tilting accuracy (sec.)	60"
Net weight (kg)	280	
CODE NO.	4003-001	