



Small Diameter Finish Boring Head Type CBI

BORING DIAMETER FROM Ø8 - Ø40MM

FEATURES:

1. Available are three different styles enabling small diameter boring from ø8mm to ø40mm. Boring range can be within ø2mm to ø8mm if small diameter solid carbide boring bar has been employed.
2. The dial has been graduated into 50 divisions, each of which is 0.01mm on diameter. Available is a sub-dial for finer adjustment.
3. High precision internal lead screw with inner lubrication is free from the effects of chip, featuring high durability.
4. Cartridge unit is housed in a square structure with two face support, proving high stability and rigidity.

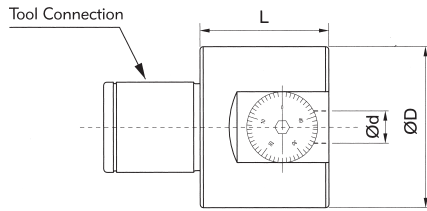

ORDER NO. Boring Head Type	Tool Connection	Ød Internal Diameter	ØD External Diameter	Length mm	Feed mm	kg Weight	CODE NO.
CBI4	VBK4	10	39	32	0 - 2	0.4	3220-390
CBI5	VBK5	12	50	40	0 - 3.5	0.8	3220-391
CBI6	VBK6	16	64	50	0 - 5	1.2	3220-392

ORDER NO.	D mm	D1 mm	Applicable Carbide Tool Holder	CODE NO.
EC1608	16	8	SC08-M5-....	3220-393
EC1610	16	10	SC10-M6-....	3220-394
EC1612	16	12	SC12-M6-....	3220-395



Small Diameter Boring Head CBI4

BORING DIAMETER FROM Ø8 - Ø20MM

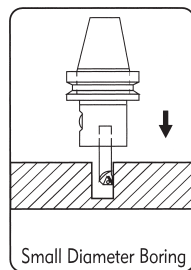

ORDER NO.	ØD mm	Ød mm	L mm	L2 mm	H mm	Insert	Clamp Screw	Wrench	CODE NO.
BJ1008-32		8	64	32		TB..0601..	MS2005A	TF6	3220-440
BJ1010-40		10	72	40		TP..0902..	MS2506A	TF9	3220-401
BJ1012-45		12	77	27		TP..1103..	MS3008A	TF9	3220-402
BJ1016-45		16	77	27					3220-403
BJ1020-45		20	77	27					3220-404
※BJ16-8PCS	BJ1008-32	BJ1010-40	BJ1012-45	BJ1016-45	BJ1020-45				3220-405



Small Diameter Boring Head CBI6

BORING DIAMETER FROM Ø8 - Ø40MM

※ In Box Package

※ Note: Outstretch of small diameter boring is better within 3 times of its diameter when in use.

ORDER NO.	ØD mm	Ød mm	L mm	L2 mm	H mm	Insert	Clamp Screw	Wrench	CODE NO.
BJ1608-32		8	74	32		TB..0601..	MS2005A	TF6	3220-406
BJ1610-40		10	75	40		TP..0902..	MS2506A	TF9	3220-407
BJ1612-53		12	85	53		TP..1103..	MS3008A	TF9	3220-408
BJ1616-68		16	100	68					3220-409
BJ1620-83		20	115	83					3220-410
BJ1625-90		25	122	90					3220-411
BJ1630-90		30	122	90					3220-412
BJ1640-90		40	122	90					3220-413
※BJ16-8PCS	BJ1608-32	BJ1610-40	BJ1612-53	BJ1616-68					3220-414
	BJ1620-83	BJ1625-90	BJ1630-90	BJ1640-90					