



EDM Wire

(Brass & Copper)

NEW



FEATURES

CHEMICAL COMPOSITION

65/35 brass equivalent to Alloy No. JIS - H3260 C2700

NO ACID-CORROSION AND NO DAMAGE TO RESINS

The special treatment avoids acid-corrosion on machine and work piece.

HIGH SURFACE QUALITY

The special treatment makes the wire surface smooth, free from dirt, rust and grease that causes inefficiency to electric discharge.

STANDARD WEIGHT CONTROL

By perfect control in process, we obtain the standard weight per coil that enables us to maintain the stability of processing time and the accuracy of drawing.

NO WELDMENT

The rough surface caused by welding could affect the quality and accuracy of performance. The welded wire tends to break that wastes the time to re-thread.

HIGH-DIMENSIONAL PRECISION

Wire diameter tolerance and roundness tolerance are both limited to $1/ \mu m$.

OUTSTANDING STRAIGHTNESS

Outstanding straightness ensures automatic threading successfully.

BRASS & COPPER

Zn COATING IS ALSO AVAILABLE

SPECIFICATION

ORDER NO.	WIRE TYPE	DIAMETER		DIAMETER TOLERANCE (mm)	BREAKING LOAD (kg)	TENSILE STRENGTH (N/mm ²)	ELONGATION (%)	SUITFUL WORKING STYLE	CODE NO.
		inch	mm						
VEW-10H	HARD	0.004	0.10	± 0.001	0.78	980 ≤	0.4 ≤	STRAIGHT CUTTING a.PASS CUTTING b.ROUGH CUTTING c.FINISH CUTTING	2009-001
VEW-15H		0.006	0.15		1.73				2009-002
VEW-20H		0.008	0.20		3.14				2009-003
VEW-25H		0.010	0.25		4.92				2009-004
VEW-30H		0.012	0.30		7.07				2009-005
VEW-33H		0.013	0.33		8.55				2009-006
VEW-20S	SOFT	0.008	0.20	± 0.001	1.41	441 ≤	15 ≤	ANGLE CUTTING	2009-010
VEW-25S		0.010	0.25		2.21				2009-011
VEW-30S		0.012	0.30		3.18				2009-012

THE PACKING USED A STANDARD COIL.

HERE SHOW 3 KINDS OF COIL PACKING OF TYPE FOR CHOICE. THE POPULAR IS

P-5R (5kgs) . OTHER COIL TYPE , WEIGHT. WILL BE AVAILABLE.

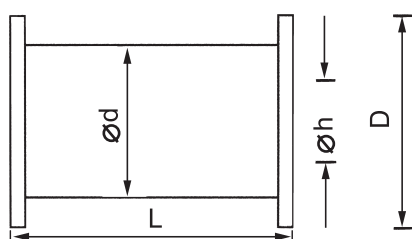

PACKING COIL TYPE	COIL SHAPE	WIGHT OF WIRE ON COIL (kg)	DIAM- THE OF WIRE (mm)	D (mm)	d (mm)	L (mm)	h (mm)	LENGTH OF WIRE ON COIL (M)	NUMBER OF COILS /BOX	CODE NO.
P-3R		3	0.10 0.15 0.20 0.25	130	80	110	20	39360 18750 10988 6932	6	2009-021
P-5R		5	0.20 0.25 0.30 0.33	160	90	114	20	18314 11553 8001 6750	4	2009-022
K-125		3.5	0.2 0.25	125	80	125	20	5600 4725	4	2009-023
K-160		7	0.20 0.25	160	100	160	22	25640 16174	2	2009-024